



Solenoid, rectangular large 25 x 88 mm for Magnet switch 3SE66.7-2CA0.
Position: is mounted offset by 90° from the contact block

product brand name	SIRIUS	
product designation	Magnetically operated switch	
design of the product	coded magnet, rectangular	
product type designation	3SE67	
General technical data		
product feature	90° offset	
protection class IP	IP67	
Substance Prohibitance (Date)	07/01/2006	
Weight	0.037 kg	
height of the sensor	25 mm	
length of the sensor	7 mm	
width of the sensor	88 mm	
Ambient conditions		
ambient temperature during operation	-25 ... +70 °C	
Enclosure		
material of the enclosure	plastic	
Installation/ mounting/ dimensions		
fastening method	screw fixing	
Approvals Certificates		
General Product Approval	EMV	other



other	Dangerous goods	Environment
-------	-----------------	-------------

[Confirmation](#)

[Transport Information](#)

[Environmental Confirmations](#)

Further information

Information on the packaging
<https://support.industry.siemens.com/cs/ww/en/view/109813875>
 Information for data generation and storage
<https://support.industry.siemens.com/cs/ww/en/view/109995012>
 Information- and Downloadcenter (Catalogs, Brochures,...)
<https://www.siemens.com/ic10>
 Industry Mall (Online ordering system)

<https://mall.industry.siemens.com/mall/en/en/Catalog/product?mlfb=3SE6724-2CA>

Cax online generator

<https://support.automation.siemens.com/WW/CAXorder/default.aspx?lang=en&mlfb=3SE6724-2CA>

Service&Support (Manuals, Certificates, Characteristics, FAQs,...)

<https://support.industry.siemens.com/cs/ww/en/ps/3SE6724-2CA>

Image database (product images, 2D dimension drawings, 3D models, device circuit diagrams, EPLAN macros, ...)

https://www.automation.siemens.com/bilddb/cax_de.aspx?mlfb=3SE6724-2CA&lang=en

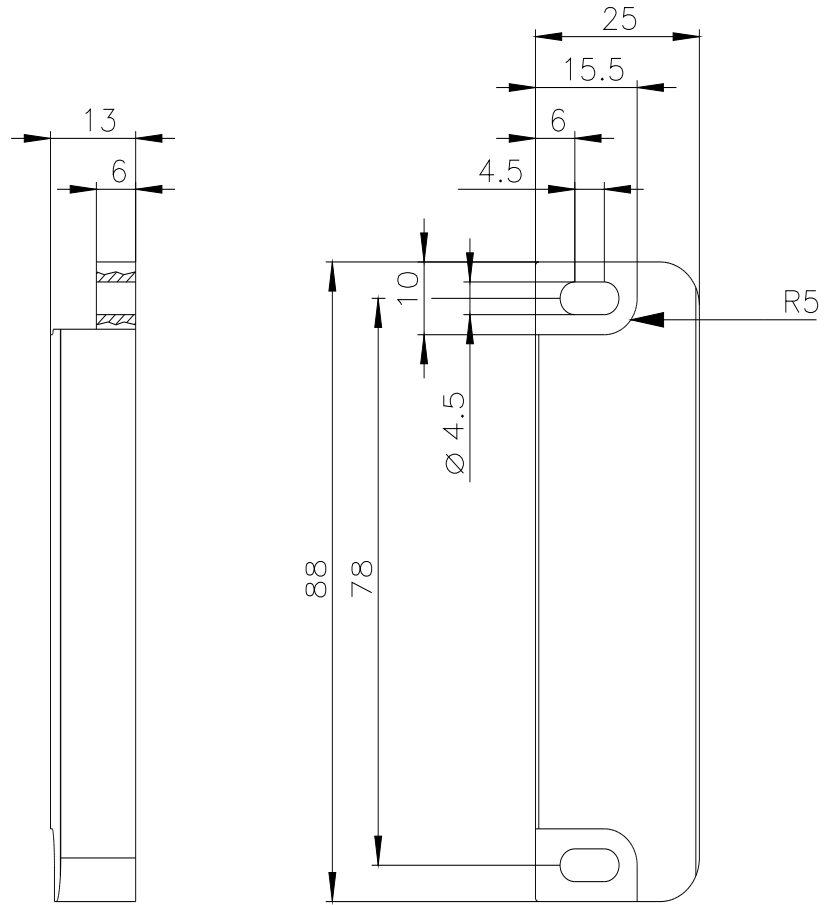

last modified:

5/8/2025 