



shunt release 20-24 V AC, 50/60 Hz, 100% OP 20-70 V AC, 50/60 Hz, 5 s switch-on duration 20-70 V DC, 5 s switch-on duration with spring-loaded terminal for 3RV2 motor starter protector/circuit breaker

product brand name	SIRIUS
product category	Auxiliary release
product designation	shunt release
product type designation	3RV29
suitability for use	motor circuit breaker
<b>General technical data</b>	
certificate of suitability	CE / UL / CSA
size of the circuit-breaker	S00, S0, S2, S3
closing power at DC minimum	13 W
insulation voltage	
• rated value	690 V
• with degree of pollution 3 at AC rated value	690 V
degree of pollution	3
protection class IP on the front according to IEC 60529	IP20
break time maximum	20 ms
reference code according to DIN 40719 extended according to IEC 204-2 according to IEC 750	F
reference code according to EN 61346-2	F
Substance Prohibitance (Date)	05/01/2012
Weight	0.138 kg
type of voltage of the control supply voltage	AC
control supply voltage 1 at AC	
• at 50 Hz	20 ... 24 V
• at 60 Hz	20 ... 24 V
control supply voltage frequency 1	50 ... 60 Hz
number of NC contacts for auxiliary contacts instantaneous contact	0
number of NO contacts for auxiliary contacts	
• instantaneous contact	0
• leading contact	0
number of CO contacts of auxiliary contacts instantaneous contact	0
<b>Ambient conditions</b>	
ambient temperature	
• during operation	-20 ... +60 °C
• during storage	-50 ... +80 °C
<b>Electrical Safety</b>	
protection class IP on the front according to IEC 60529	IP20
touch protection on the front according to IEC 60529	finger-safe, for vertical contact from the front
<b>Short-circuit protection</b>	
design of short-circuit protection	fuse

Installation/ mounting/ dimensions	
fastening method	snap-on mounting
height	90 mm
width	19 mm
depth	68 mm

Connections/ Terminals	
type of electrical connection for auxiliary and control circuit	spring-loaded terminals

Approvals Certificates	
General Product Approval	Test Certificates



[Special Test Certificate](#)

[Type Test Certificates/Test Report](#)

### Maritime application



other	Railway	Environment
-------	---------	-------------

[Miscellaneous](#)



[Confirmation](#)



[Special Test Certificate](#)

[Environmental Confirmations](#)

### Further information

#### Information on the packaging

<https://support.industry.siemens.com/cs/ww/en/view/109813875>

#### Information for data generation and storage

<https://support.industry.siemens.com/cs/ww/en/view/109995012>

#### Information- and Downloadcenter (Catalogs, Brochures,...)

<https://www.siemens.com/ic10>

#### Industry Mall (Online ordering system)

<https://mall.industry.siemens.com/mall/en/en/Catalog/product?mlfb=3RV2902-2DB0>

#### Cax online generator

<https://support.automation.siemens.com/WW/CAXorder/default.aspx?lang=en&mlfb=3RV2902-2DB0>

#### Service&Support (Manuals, Certificates, Characteristics, FAQs,...)

<https://support.industry.siemens.com/cs/ww/en/ps/3RV2902-2DB0>

#### Image database (product images, 2D dimension drawings, 3D models, device circuit diagrams, EPLAN macros, ...)

[https://www.automation.siemens.com/bilddb/cax\\_de.aspx?mlfb=3RV2902-2DB0&lang=en](https://www.automation.siemens.com/bilddb/cax_de.aspx?mlfb=3RV2902-2DB0&lang=en)

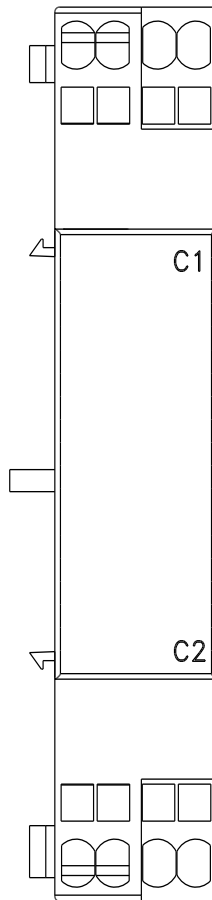
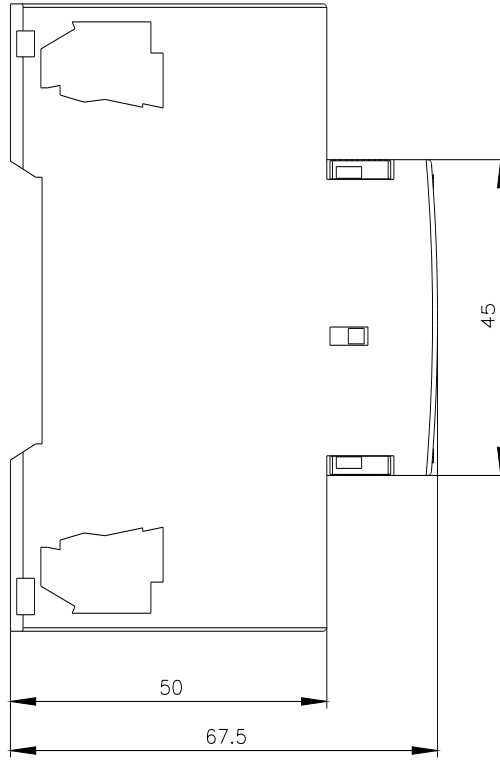
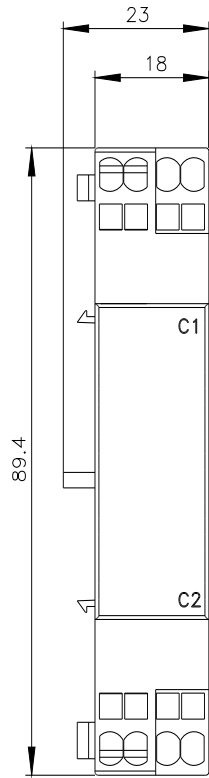

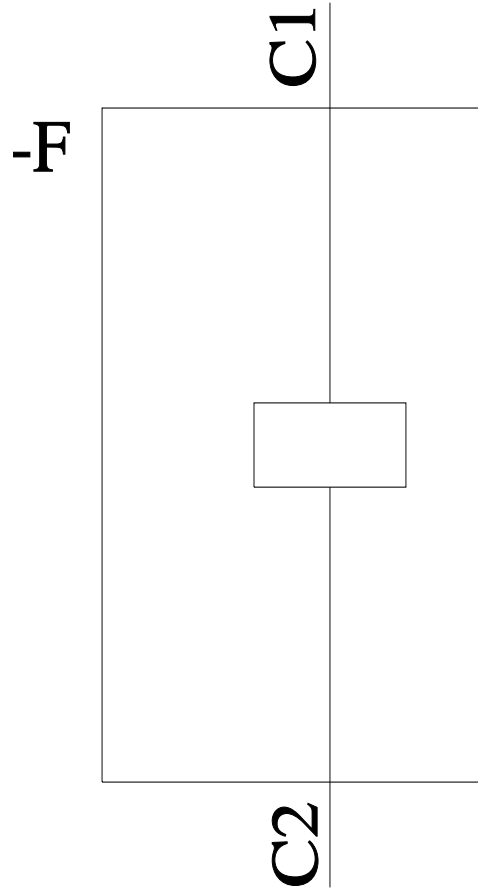

---

last modified:

4/2/2025 