



additional load unit, 180-255 V AC, 50/60 Hz, for contactors 3RT2.1 and auxiliary contactors 3RH2

|  |   |                   |
|--|---|-------------------|
| product brand name                                     | SIRIUS  |                   |
| product category                                       | Additional load modules                             |                   |
| product designation                                    | plug-in additional load module                      |                   |
| product type designation                               | 3RT29   |                   |
| suitability for use                                    | for 3RT2.1 contactors and 3RH2 auxiliary contactors |                   |
| <b>General technical data</b>                          |   |                   |
| certificate of suitability                             | CE / UL / CSA                                       |                   |
| size of contactor                                      | S00   |                   |
| Substance Prohibitance (Date)                          | 10/01/2009  |                   |
| SVHC substance name                                    | Lead - 7439-92-1                                    |                   |
| Weight   | 0.007 kg  |                   |
| type of voltage of the control supply voltage          | AC  |                   |
| control supply voltage at AC                           |   |                   |
| • at 50 Hz rated value                                 | 180 ... 255 V                                       |                   |
| • at 60 Hz rated value                                 | 180 ... 255 V                                       |                   |
| control supply voltage frequency                       |   |                   |
| • 1 rated value  | 50 Hz   |                   |
| • 2 rated value  | 60 Hz   |                   |
| <b>Ambient conditions</b>                              |   |                   |
| ambient temperature                                    |   |                   |
| • during operation                                     | -25 ... +60 °C                                      |                   |
| • during storage                                       | -40 ... +80 °C                                      |                   |
| <b>Environmental footprint</b>                         |   |                   |
| Environmental Product Declaration (EPD)                | Yes   |                   |
| global warming potential [CO2 eq] total                | 7.04 kg   |                   |
| global warming potential [CO2 eq] during manufacturing | 0.089 kg  |                   |
| global warming potential [CO2 eq] during operation     | 6.96 kg   |                   |
| global warming potential [CO2 eq] after end of life    | -0.0061 kg  |                   |
| <b>Installation/ mounting/ dimensions</b>              |   |                   |
| mounting position                                      | any   |                   |
| fastening method                                       | clip-on   |                   |
| height   | 46 mm   |                   |
| width  | 28 mm   |                   |
| depth  | 9 mm  |                   |
| <b>Approvals Certificates</b>                          |   |                   |
| General Product Approval                               | EMV   | Test Certificates |



[Special Test Certificate](#)

Maritime application

other



[Miscellaneous](#)



other

Railway

Environment

[Confirmation](#)

[Special Test Certificate](#)



[Environmental Confirmations](#)

Further information

Information on the packaging

<https://support.industry.siemens.com/cs/ww/en/view/109813875>

Information for data generation and storage

<https://support.industry.siemens.com/cs/ww/en/view/109995012>

Information- and Downloadcenter (Catalogs, Brochures,...)

<https://www.siemens.com/ic10>

Industry Mall (Online ordering system)

<https://mall.industry.siemens.com/mall/en/en/Catalog/product?mlfb=3RT2916-1GA00>

Cax online generator

<https://support.automation.siemens.com/WW/CAXorder/default.aspx?lang=en&mlfb=3RT2916-1GA00>

Service&Support (Manuals, Certificates, Characteristics, FAQs,...)

<https://support.industry.siemens.com/cs/ww/en/ps/3RT2916-1GA00>

Image database (product images, 2D dimension drawings, 3D models, device circuit diagrams, EPLAN macros, ...)

[https://www.automation.siemens.com/bilddb/cax\\_de.aspx?mlfb=3RT2916-1GA00&lang=en](https://www.automation.siemens.com/bilddb/cax_de.aspx?mlfb=3RT2916-1GA00&lang=en)

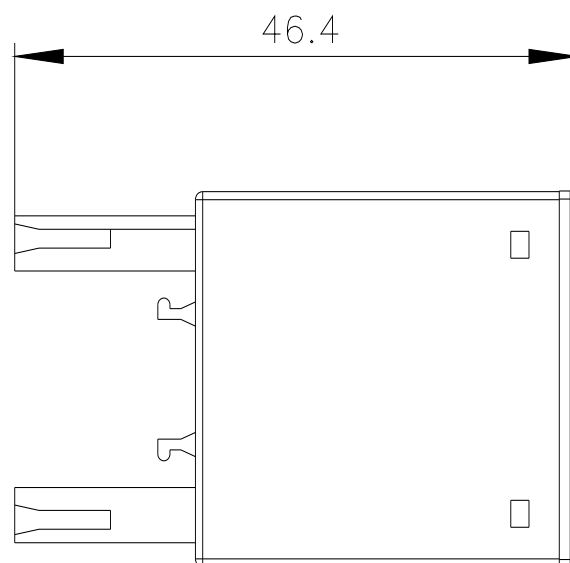
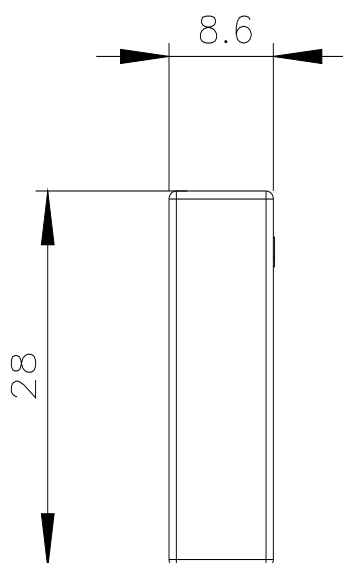

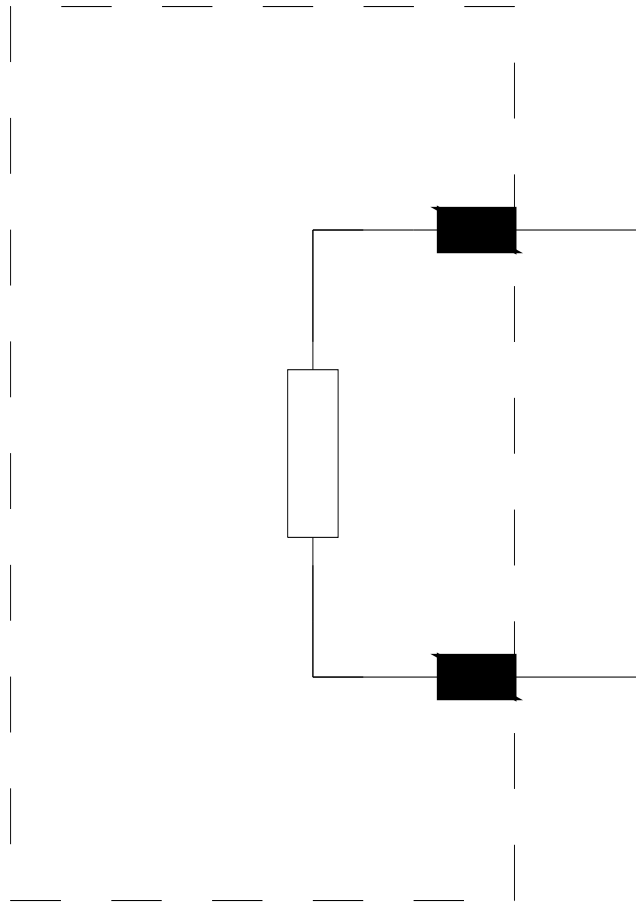

---

last modified:

4/2/2025 