



power contactor, AC-3e/AC-3, 25 A, 11 kW / 400 V, 3-pole, 48 V DC, auxiliary contacts: 1 NO + 1 NC, screw terminal, size: S0

|                                                                                                              |                          |
|--------------------------------------------------------------------------------------------------------------|--------------------------|
| <b>product brand name</b>                                                                                    | SIRIUS                   |
| <b>product designation</b>                                                                                   | Power contactor          |
| <b>product type designation</b>                                                                              | 3RT2                     |
| <b>General technical data</b>                                                                                |                          |
| <b>size of contactor</b>                                                                                     | S0                       |
| <b>product extension</b>                                                                                     |                          |
| • function module for communication                                                                          | No                       |
| • auxiliary switch                                                                                           | Yes                      |
| <b>power loss [W] for rated value of the current</b>                                                         |                          |
| • at AC in hot operating state                                                                               | 5.7 W                    |
| • at AC in hot operating state per pole                                                                      | 1.9 W                    |
| • without load current share typical                                                                         | 5.9 W                    |
| <b>type of calculation of power loss depending on pole</b>                                                   | quadratic                |
| <b>insulation voltage</b>                                                                                    |                          |
| • of main circuit with degree of pollution 3 rated value                                                     | 690 V                    |
| • of auxiliary circuit with degree of pollution 3 rated value                                                | 690 V                    |
| <b>surge voltage resistance</b>                                                                              |                          |
| • of main circuit rated value                                                                                | 6 kV                     |
| • of auxiliary circuit rated value                                                                           | 6 kV                     |
| maximum permissible voltage for protective separation between coil and main contacts according to EN 60947-1 | 400 V                    |
| <b>shock resistance at rectangular impulse</b>                                                               |                          |
| • at DC                                                                                                      | 10g / 5 ms, 7,5g / 10 ms |
| <b>shock resistance with sine pulse</b>                                                                      |                          |
| • at DC                                                                                                      | 15g / 5 ms, 10g / 10 ms  |
| <b>mechanical service life (operating cycles)</b>                                                            |                          |
| • of contactor typical                                                                                       | 10 000 000               |
| • of the contactor with added electronically optimized auxiliary switch block typical                        | 5 000 000                |
| • of the contactor with added auxiliary switch block typical                                                 | 10 000 000               |
| <b>reference code according to IEC 81346-2</b>                                                               | Q                        |
| <b>Substance Prohibition (Date)</b>                                                                          | 10/01/2009               |
| <b>Weight</b>                                                                                                | 0.592 kg                 |
| <b>Ambient conditions</b>                                                                                    |                          |
| installation altitude at height above sea level maximum                                                      | 2 000 m                  |
| <b>ambient temperature</b>                                                                                   |                          |
| • during operation                                                                                           | -25 ... +60 °C           |
| • during storage                                                                                             | -55 ... +80 °C           |
| <b>relative humidity minimum</b>                                                                             | 10 %                     |
| <b>relative humidity at 55 °C according to IEC 60068-2-30 maximum</b>                                        | 95 %                     |

| Environmental footprint                                                |                    |
|------------------------------------------------------------------------|--------------------|
| Environmental Product Declaration(EPD)                                 | Yes                |
| global warming potential [CO2 eq] total                                | 221 kg             |
| global warming potential [CO2 eq] during manufacturing                 | 2.65 kg            |
| global warming potential [CO2 eq] during operation                     | 219 kg             |
| global warming potential [CO2 eq] after end of life                    | -0.639 kg          |
| Main circuit                                                           |                    |
| <b>number of poles for main current circuit</b>                        | 3                  |
| <b>number of NO contacts for main contacts</b>                         | 3                  |
| <b>number of NC contacts for main contacts</b>                         | 0                  |
| <b>operating voltage</b>                                               |                    |
| • at AC-3 rated value maximum                                          | 690 V              |
| • at AC-3e rated value maximum                                         | 690 V              |
| <b>operational current</b>                                             |                    |
| • at AC-1 at 400 V at ambient temperature 40 °C rated value            | 40 A               |
| • at AC-1                                                              |                    |
| — up to 690 V at ambient temperature 40 °C rated value                 | 40 A               |
| — up to 690 V at ambient temperature 60 °C rated value                 | 35 A               |
| • at AC-3                                                              |                    |
| — at 400 V rated value                                                 | 25 A               |
| — at 500 V rated value                                                 | 18 A               |
| — at 690 V rated value                                                 | 13 A               |
| • at AC-3e                                                             |                    |
| — at 400 V rated value                                                 | 25 A               |
| — at 500 V rated value                                                 | 18 A               |
| — at 690 V rated value                                                 | 13 A               |
| • at AC-4 at 400 V rated value                                         | 15.5 A             |
| • at AC-5a up to 690 V rated value                                     | 35.2 A             |
| • at AC-5b up to 400 V rated value                                     | 20.7 A             |
| • at AC-6a                                                             |                    |
| — up to 230 V for current peak value n=20 rated value                  | 20.2 A             |
| — up to 400 V for current peak value n=20 rated value                  | 20.2 A             |
| — up to 500 V for current peak value n=20 rated value                  | 20.2 A             |
| — up to 690 V for current peak value n=20 rated value                  | 12.9 A             |
| • at AC-6a                                                             |                    |
| — up to 230 V for current peak value n=30 rated value                  | 13.5 A             |
| — up to 400 V for current peak value n=30 rated value                  | 13.5 A             |
| — up to 500 V for current peak value n=30 rated value                  | 13.5 A             |
| — up to 690 V for current peak value n=30 rated value                  | 13 A               |
| minimum cross-section in main circuit at maximum AC-1 rated value      | 10 mm <sup>2</sup> |
| <b>operational current for approx. 200000 operating cycles at AC-4</b> |                    |
| • at 400 V rated value                                                 | 9 A                |
| • at 690 V rated value                                                 | 9 A                |
| <b>operational current</b>                                             |                    |
| • <b>at 1 current path at DC-1</b>                                     |                    |
| — at 24 V rated value                                                  | 35 A               |
| — at 60 V rated value                                                  | 20 A               |
| — at 110 V rated value                                                 | 4.5 A              |
| — at 220 V rated value                                                 | 1 A                |
| — at 440 V rated value                                                 | 0.4 A              |
| — at 600 V rated value                                                 | 0.25 A             |
| • <b>with 2 current paths in series at DC-1</b>                        |                    |
| — at 24 V rated value                                                  | 35 A               |
| — at 60 V rated value                                                  | 35 A               |
| — at 110 V rated value                                                 | 35 A               |
| — at 220 V rated value                                                 | 5 A                |
| — at 440 V rated value                                                 | 1 A                |

|                                                                                                                                                                                                                                                                                                                                                                                                                                                                                                                                                                                                                                                                                                                                                                                                                                                                                                                                                                                                                                                                                                                                                                                                                                                         |                                                                                                                                                                                                                                                                                                               |
|---------------------------------------------------------------------------------------------------------------------------------------------------------------------------------------------------------------------------------------------------------------------------------------------------------------------------------------------------------------------------------------------------------------------------------------------------------------------------------------------------------------------------------------------------------------------------------------------------------------------------------------------------------------------------------------------------------------------------------------------------------------------------------------------------------------------------------------------------------------------------------------------------------------------------------------------------------------------------------------------------------------------------------------------------------------------------------------------------------------------------------------------------------------------------------------------------------------------------------------------------------|---------------------------------------------------------------------------------------------------------------------------------------------------------------------------------------------------------------------------------------------------------------------------------------------------------------|
| <ul style="list-style-type: none"> <li>— at 600 V rated value</li> </ul>                                                                                                                                                                                                                                                                                                                                                                                                                                                                                                                                                                                                                                                                                                                                                                                                                                                                                                                                                                                                                                                                                                                                                                                | 0.8 A                                                                                                                                                                                                                                                                                                         |
| <ul style="list-style-type: none"> <li>● <b>with 3 current paths in series at DC-1</b> <ul style="list-style-type: none"> <li>— at 24 V rated value</li> <li>— at 60 V rated value</li> <li>— at 110 V rated value</li> <li>— at 220 V rated value</li> <li>— at 440 V rated value</li> <li>— at 600 V rated value</li> </ul> </li> <li>● <b>at 1 current path at DC-3 at DC-5</b> <ul style="list-style-type: none"> <li>— at 24 V rated value</li> <li>— at 60 V rated value</li> <li>— at 110 V rated value</li> <li>— at 220 V rated value</li> <li>— at 440 V rated value</li> <li>— at 600 V rated value</li> </ul> </li> <li>● <b>with 2 current paths in series at DC-3 at DC-5</b> <ul style="list-style-type: none"> <li>— at 24 V rated value</li> <li>— at 60 V rated value</li> <li>— at 110 V rated value</li> <li>— at 220 V rated value</li> <li>— at 440 V rated value</li> <li>— at 600 V rated value</li> </ul> </li> <li>● <b>with 3 current paths in series at DC-3 at DC-5</b> <ul style="list-style-type: none"> <li>— at 24 V rated value</li> <li>— at 60 V rated value</li> <li>— at 110 V rated value</li> <li>— at 220 V rated value</li> <li>— at 440 V rated value</li> <li>— at 600 V rated value</li> </ul> </li> </ul> | 35 A<br>35 A<br>35 A<br>35 A<br>2.9 A<br>1.4 A<br><br>20 A<br>5 A<br>2.5 A<br>1 A<br>0.09 A<br>0.06 A<br><br>35 A<br>35 A<br>15 A<br>3 A<br>0.27 A<br>0.16 A<br><br>35 A<br>35 A<br>35 A<br>10 A<br>0.6 A<br>0.6 A                                                                                            |
| <b>operating power</b> <ul style="list-style-type: none"> <li>● at AC-3               <ul style="list-style-type: none"> <li>— at 230 V rated value</li> <li>— at 400 V rated value</li> <li>— at 500 V rated value</li> <li>— at 690 V rated value</li> </ul> </li> <li>● at AC-3e               <ul style="list-style-type: none"> <li>— at 230 V rated value</li> <li>— at 400 V rated value</li> <li>— at 500 V rated value</li> <li>— at 690 V rated value</li> </ul> </li> </ul>                                                                                                                                                                                                                                                                                                                                                                                                                                                                                                                                                                                                                                                                                                                                                                  | 5.5 kW<br>11 kW<br>11 kW<br>11 kW<br><br>5.5 kW<br>11 kW<br>11 kW<br>11 kW                                                                                                                                                                                                                                    |
| <b>operating power for approx. 200000 operating cycles at AC-4</b> <ul style="list-style-type: none"> <li>● at 400 V rated value</li> <li>● at 690 V rated value</li> </ul>                                                                                                                                                                                                                                                                                                                                                                                                                                                                                                                                                                                                                                                                                                                                                                                                                                                                                                                                                                                                                                                                             | 4.4 kW<br>7.7 kW                                                                                                                                                                                                                                                                                              |
| <b>operating apparent power at AC-6a</b> <ul style="list-style-type: none"> <li>● up to 230 V for current peak value n=20 rated value</li> <li>● up to 400 V for current peak value n=20 rated value</li> <li>● up to 500 V for current peak value n=20 rated value</li> <li>● up to 690 V for current peak value n=20 rated value</li> </ul>                                                                                                                                                                                                                                                                                                                                                                                                                                                                                                                                                                                                                                                                                                                                                                                                                                                                                                           | 8 kVA<br>13.9 kVA<br>17.4 kVA<br>15.4 kVA                                                                                                                                                                                                                                                                     |
| <b>operating apparent power at AC-6a</b> <ul style="list-style-type: none"> <li>● up to 230 V for current peak value n=30 rated value</li> <li>● up to 400 V for current peak value n=30 rated value</li> <li>● up to 500 V for current peak value n=30 rated value</li> <li>● up to 690 V for current peak value n=30 rated value</li> </ul>                                                                                                                                                                                                                                                                                                                                                                                                                                                                                                                                                                                                                                                                                                                                                                                                                                                                                                           | 5.3 kVA<br>9.3 kVA<br>11.6 kVA<br>15.5 kVA                                                                                                                                                                                                                                                                    |
| <b>short-time withstand current in cold operating state up to 40 °C</b> <ul style="list-style-type: none"> <li>● limited to 1 s switching at zero current maximum</li> <li>● limited to 5 s switching at zero current maximum</li> <li>● limited to 10 s switching at zero current maximum</li> <li>● limited to 30 s switching at zero current maximum</li> <li>● limited to 60 s switching at zero current maximum</li> </ul>                                                                                                                                                                                                                                                                                                                                                                                                                                                                                                                                                                                                                                                                                                                                                                                                                         | 375 A; Use minimum cross-section acc. to AC-1 rated value<br>300 A; Use minimum cross-section acc. to AC-1 rated value<br>210 A; Use minimum cross-section acc. to AC-1 rated value<br>144 A; Use minimum cross-section acc. to AC-1 rated value<br>118 A; Use minimum cross-section acc. to AC-1 rated value |

|                                                                                       |                                                 |
|---------------------------------------------------------------------------------------|-------------------------------------------------|
| <b>no-load switching frequency</b>                                                    |                                                 |
| • at DC                                                                               | 1 500 1/h                                       |
| <b>operating frequency</b>                                                            |                                                 |
| • at AC-1 maximum                                                                     | 1 000 1/h                                       |
| • at AC-2 maximum                                                                     | 750 1/h                                         |
| • at AC-3 maximum                                                                     | 750 1/h                                         |
| • at AC-3e                                                                            |                                                 |
| — maximum                                                                             | 750 1/h                                         |
| • at AC-4 maximum                                                                     | 250 1/h                                         |
| <b>Control circuit/ Control</b>                                                       |                                                 |
| <b>type of voltage of the control supply voltage</b>                                  | DC                                              |
| <b>control supply voltage at DC rated value</b>                                       | 48 V                                            |
| <b>operating range factor control supply voltage rated value of magnet coil at DC</b> |                                                 |
| • initial value                                                                       | 0.8                                             |
| • full-scale value                                                                    | 1.1                                             |
| <b>closing power of magnet coil at DC</b>                                             | 5.9 W                                           |
| <b>holding power of magnet coil at DC</b>                                             | 5.9 W                                           |
| <b>closing delay</b>                                                                  |                                                 |
| • at DC                                                                               | 50 ... 170 ms                                   |
| <b>opening delay</b>                                                                  |                                                 |
| • at DC                                                                               | 15 ... 18 ms                                    |
| <b>arcing time</b>                                                                    | 10 ... 10 ms                                    |
| <b>control version of the switch operating mechanism</b>                              | Standard A1 - A2                                |
| <b>Auxiliary circuit</b>                                                              |                                                 |
| number of NC contacts for auxiliary contacts instantaneous contact                    | 1                                               |
| number of NO contacts for auxiliary contacts instantaneous contact                    | 1                                               |
| operational current at AC-12 maximum                                                  | 10 A                                            |
| <b>operational current at AC-15</b>                                                   |                                                 |
| • at 230 V rated value                                                                | 10 A                                            |
| • at 400 V rated value                                                                | 3 A                                             |
| • at 500 V rated value                                                                | 2 A                                             |
| • at 690 V rated value                                                                | 1 A                                             |
| <b>operational current at DC-12</b>                                                   |                                                 |
| • at 24 V rated value                                                                 | 10 A                                            |
| • at 48 V rated value                                                                 | 6 A                                             |
| • at 60 V rated value                                                                 | 6 A                                             |
| • at 110 V rated value                                                                | 3 A                                             |
| • at 125 V rated value                                                                | 2 A                                             |
| • at 220 V rated value                                                                | 1 A                                             |
| • at 600 V rated value                                                                | 0.15 A                                          |
| <b>operational current at DC-13</b>                                                   |                                                 |
| • at 24 V rated value                                                                 | 10 A                                            |
| • at 48 V rated value                                                                 | 2 A                                             |
| • at 60 V rated value                                                                 | 2 A                                             |
| • at 110 V rated value                                                                | 1 A                                             |
| • at 125 V rated value                                                                | 0.9 A                                           |
| • at 220 V rated value                                                                | 0.3 A                                           |
| • at 600 V rated value                                                                | 0.1 A                                           |
| <b>contact reliability of auxiliary contacts</b>                                      | 1 faulty switching per 100 million (17 V, 1 mA) |
| <b>UL/CSA ratings</b>                                                                 |                                                 |
| <b>full-load current (FLA) for 3-phase AC motor</b>                                   |                                                 |
| • at 480 V rated value                                                                | 21 A                                            |
| • at 600 V rated value                                                                | 22 A                                            |
| <b>yielded mechanical performance [hp]</b>                                            |                                                 |
| • for single-phase AC motor                                                           |                                                 |
| — at 110/120 V rated value                                                            | 2 hp                                            |
| — at 230 V rated value                                                                | 3 hp                                            |
| • for 3-phase AC motor                                                                |                                                 |

|                                                                                                                                                                                                                                                                                                                                                                                                                                                                                                                               |                                                                                                                                                                                                                                                                    |
|-------------------------------------------------------------------------------------------------------------------------------------------------------------------------------------------------------------------------------------------------------------------------------------------------------------------------------------------------------------------------------------------------------------------------------------------------------------------------------------------------------------------------------|--------------------------------------------------------------------------------------------------------------------------------------------------------------------------------------------------------------------------------------------------------------------|
| — at 200/208 V rated value                                                                                                                                                                                                                                                                                                                                                                                                                                                                                                    | 5 hp                                                                                                                                                                                                                                                               |
| — at 220/230 V rated value                                                                                                                                                                                                                                                                                                                                                                                                                                                                                                    | 7.5 hp                                                                                                                                                                                                                                                             |
| — at 460/480 V rated value                                                                                                                                                                                                                                                                                                                                                                                                                                                                                                    | 15 hp                                                                                                                                                                                                                                                              |
| — at 575/600 V rated value                                                                                                                                                                                                                                                                                                                                                                                                                                                                                                    | 20 hp                                                                                                                                                                                                                                                              |
| <b>contact rating of auxiliary contacts according to UL</b>                                                                                                                                                                                                                                                                                                                                                                                                                                                                   | A600 / P600                                                                                                                                                                                                                                                        |
| <b>Short-circuit protection</b>                                                                                                                                                                                                                                                                                                                                                                                                                                                                                               |                                                                                                                                                                                                                                                                    |
| design of the miniature circuit breaker for short-circuit protection of the auxiliary circuit up to 230 V                                                                                                                                                                                                                                                                                                                                                                                                                     | C characteristic: 10 A; 0.4 kA                                                                                                                                                                                                                                     |
| <b>design of the fuse link</b>                                                                                                                                                                                                                                                                                                                                                                                                                                                                                                |                                                                                                                                                                                                                                                                    |
| <ul style="list-style-type: none"> <li>• for short-circuit protection of the main circuit <ul style="list-style-type: none"> <li>— with type of coordination 1 required</li> <li>— with type of coordination 2 required</li> </ul> </li> <li>• for short-circuit protection of the auxiliary switch required</li> </ul>                                                                                                                                                                                                       | gG: 100 A (690 V, 100 kA), aM: 50 A (690 V, 100 kA), BS88: 100 A (415 V, 80 kA)<br>gG: 35 A (690 V, 100 kA), aM: 20 A (690 V, 100 kA), BS88: 35 A (415 V, 80 kA)<br>gG: 10 A (500 V, 1 kA)                                                                         |
| <b>Installation/ mounting/ dimensions</b>                                                                                                                                                                                                                                                                                                                                                                                                                                                                                     |                                                                                                                                                                                                                                                                    |
| <b>mounting position</b>                                                                                                                                                                                                                                                                                                                                                                                                                                                                                                      | +/-180° rotation possible on vertical mounting surface; can be tilted forward and backward by +/- 22.5° on vertical mounting surface                                                                                                                               |
| fastening method side-by-side mounting                                                                                                                                                                                                                                                                                                                                                                                                                                                                                        | Yes                                                                                                                                                                                                                                                                |
| <b>fastening method</b>                                                                                                                                                                                                                                                                                                                                                                                                                                                                                                       | screw and snap-on mounting onto 35 mm DIN rail according to DIN EN 60715                                                                                                                                                                                           |
| <b>height</b>                                                                                                                                                                                                                                                                                                                                                                                                                                                                                                                 | 85 mm                                                                                                                                                                                                                                                              |
| <b>width</b>                                                                                                                                                                                                                                                                                                                                                                                                                                                                                                                  | 45 mm                                                                                                                                                                                                                                                              |
| <b>depth</b>                                                                                                                                                                                                                                                                                                                                                                                                                                                                                                                  | 107 mm                                                                                                                                                                                                                                                             |
| <b>required spacing</b>                                                                                                                                                                                                                                                                                                                                                                                                                                                                                                       |                                                                                                                                                                                                                                                                    |
| <ul style="list-style-type: none"> <li>• with side-by-side mounting <ul style="list-style-type: none"> <li>— forwards</li> <li>— upwards</li> <li>— downwards</li> <li>— at the side</li> </ul> </li> <li>• for grounded parts <ul style="list-style-type: none"> <li>— forwards</li> <li>— upwards</li> <li>— at the side</li> <li>— downwards</li> </ul> </li> <li>• for live parts <ul style="list-style-type: none"> <li>— forwards</li> <li>— upwards</li> <li>— downwards</li> <li>— at the side</li> </ul> </li> </ul> | 10 mm<br>10 mm<br>10 mm<br>0 mm<br><br>10 mm<br>10 mm<br>6 mm<br>10 mm<br><br>10 mm<br>10 mm<br>10 mm<br>6 mm                                                                                                                                                      |
| <b>Connections/ Terminals</b>                                                                                                                                                                                                                                                                                                                                                                                                                                                                                                 |                                                                                                                                                                                                                                                                    |
| <b>type of electrical connection</b>                                                                                                                                                                                                                                                                                                                                                                                                                                                                                          |                                                                                                                                                                                                                                                                    |
| <ul style="list-style-type: none"> <li>• for main current circuit</li> <li>• for auxiliary and control circuit</li> <li>• at contactor for auxiliary contacts</li> <li>• of magnet coil</li> </ul>                                                                                                                                                                                                                                                                                                                            | screw-type terminals<br>screw-type terminals<br>Screw-type terminals<br>Screw-type terminals                                                                                                                                                                       |
| <b>type of connectable conductor cross-sections</b>                                                                                                                                                                                                                                                                                                                                                                                                                                                                           |                                                                                                                                                                                                                                                                    |
| <ul style="list-style-type: none"> <li>• for main contacts <ul style="list-style-type: none"> <li>— solid</li> <li>— solid or stranded</li> <li>— finely stranded with core end processing</li> </ul> </li> <li>• for AWG cables for main contacts</li> </ul>                                                                                                                                                                                                                                                                 | 2x (1 ... 2.5 mm <sup>2</sup> ), 2x (2.5 ... 10 mm <sup>2</sup> )<br>2x (1 ... 2.5 mm <sup>2</sup> ), 2x (2.5 ... 10 mm <sup>2</sup> )<br>2x (1 ... 2.5 mm <sup>2</sup> ), 2x (2.5 ... 6 mm <sup>2</sup> ), 1x 10 mm <sup>2</sup><br>2x (16 ... 12), 2x (14 ... 8) |
| <b>connectable conductor cross-section for main contacts</b>                                                                                                                                                                                                                                                                                                                                                                                                                                                                  |                                                                                                                                                                                                                                                                    |
| <ul style="list-style-type: none"> <li>• solid</li> <li>• stranded</li> <li>• finely stranded with core end processing</li> </ul>                                                                                                                                                                                                                                                                                                                                                                                             | 1 ... 10 mm <sup>2</sup><br>1 ... 10 mm <sup>2</sup><br>1 ... 10 mm <sup>2</sup>                                                                                                                                                                                   |
| <b>connectable conductor cross-section for auxiliary contacts</b>                                                                                                                                                                                                                                                                                                                                                                                                                                                             |                                                                                                                                                                                                                                                                    |
| <ul style="list-style-type: none"> <li>• solid or stranded</li> <li>• finely stranded with core end processing</li> </ul>                                                                                                                                                                                                                                                                                                                                                                                                     | 0.5 ... 2.5 mm <sup>2</sup><br>0.5 ... 2.5 mm <sup>2</sup>                                                                                                                                                                                                         |
| <b>type of connectable conductor cross-sections</b>                                                                                                                                                                                                                                                                                                                                                                                                                                                                           |                                                                                                                                                                                                                                                                    |
| <ul style="list-style-type: none"> <li>• for auxiliary contacts <ul style="list-style-type: none"> <li>— solid or stranded</li> <li>— finely stranded with core end processing</li> </ul> </li> </ul>                                                                                                                                                                                                                                                                                                                         | 2x (0.5 ... 1.5 mm <sup>2</sup> ), 2x (0.75 ... 2.5 mm <sup>2</sup> )<br>2x (0.5 ... 1.5 mm <sup>2</sup> ), 2x (0.75 ... 2.5 mm <sup>2</sup> )                                                                                                                     |

|                                                                                       |                                |
|---------------------------------------------------------------------------------------|--------------------------------|
| • for AWG cables for auxiliary contacts                                               | 2x (20 ... 16), 2x (18 ... 14) |
| <b>AWG number as coded connectable conductor cross section for main contacts</b>      | 16 ... 8                       |
| <b>AWG number as coded connectable conductor cross section for auxiliary contacts</b> | 20 ... 14                      |

### Safety related data

|                                                                      |                                                  |
|----------------------------------------------------------------------|--------------------------------------------------|
| <b>product function</b>                                              |                                                  |
| • mirror contact according to IEC 60947-4-1                          | Yes                                              |
| • positively driven operation according to IEC 60947-5-1             | No                                               |
| • suitable for safety function                                       | Yes                                              |
| suitability for use safety-related switching OFF                     | Yes                                              |
| <b>service life maximum</b>                                          | 20 a                                             |
| <b>test wear-related service life necessary</b>                      | Yes                                              |
| <b>proportion of dangerous failures</b>                              |                                                  |
| • with low demand rate according to SN 31920                         | 40 %                                             |
| • with high demand rate according to SN 31920                        | 73 %                                             |
| <b>B10 value with high demand rate according to SN 31920</b>         | 1 000 000                                        |
| <b>failure rate [FIT] with low demand rate according to SN 31920</b> | 100 FIT                                          |
| <b>ISO 13849</b>                                                     |                                                  |
| <b>device type according to ISO 13849-1</b>                          | 3                                                |
| <b>overdimensioning according to ISO 13849-2 necessary</b>           | Yes                                              |
| <b>IEC 61508</b>                                                     |                                                  |
| <b>safety device type according to IEC 61508-2</b>                   | Type A                                           |
| <b>Electrical Safety</b>                                             |                                                  |
| <b>protection class IP on the front according to IEC 60529</b>       | IP20                                             |
| <b>touch protection on the front according to IEC 60529</b>          | finger-safe, for vertical contact from the front |

### Approvals Certificates

#### General Product Approval



[KC](#)

| General Product Approval | EMV | Test Certificates | Maritime application |
|--------------------------|-----|-------------------|----------------------|
|--------------------------|-----|-------------------|----------------------|



[Type Test Certificates/Test Report](#)

[Special Test Certificate](#)



| Maritime application | other |
|----------------------|-------|
|----------------------|-------|



[Miscellaneous](#)



| other | Railway | Dangerous goods | Environment |
|-------|---------|-----------------|-------------|
|-------|---------|-----------------|-------------|

[Confirmation](#)

[Special Test Certificate](#)

[Transport Information](#)



[Environmental Confirmations](#)

### Further information

Information on the packaging

<https://support.industry.siemens.com/cs/ww/en/view/109813875>

Information for data generation and storage

<https://support.industry.siemens.com/cs/ww/en/view/109995012>

Information- and Downloadcenter (Catalogs, Brochures,...)

<https://www.siemens.com/ic10>

Industry Mall (Online ordering system)

<https://mall.industry.siemens.com/mall/en/en/Catalog/product?mlfb=3RT2026-1BW40>

Cax online generator

<https://support.automation.siemens.com/WW/CAXorder/default.aspx?lang=en&mlfb=3RT2026-1BW40>

Service&Support (Manuals, Certificates, Characteristics, FAQs,...)

<https://support.industry.siemens.com/cs/ww/en/ps/3RT2026-1BW40>

Image database (product images, 2D dimension drawings, 3D models, device circuit diagrams, EPLAN macros, ...)

[https://www.automation.siemens.com/bilddb/cax\\_de.aspx?mlfb=3RT2026-1BW40&lang=en](https://www.automation.siemens.com/bilddb/cax_de.aspx?mlfb=3RT2026-1BW40&lang=en)

Characteristic: Tripping characteristics, I<sup>2</sup>t, Let-through current

<https://support.industry.siemens.com/cs/ww/en/ps/3RT2026-1BW40/char>

Further characteristics (e.g. electrical endurance, switching frequency)

<https://www.automation.siemens.com/bilddb/index.aspx?view=Search&mlfb=3RT2026-1BW40&objecttype=14&gridview=view1>

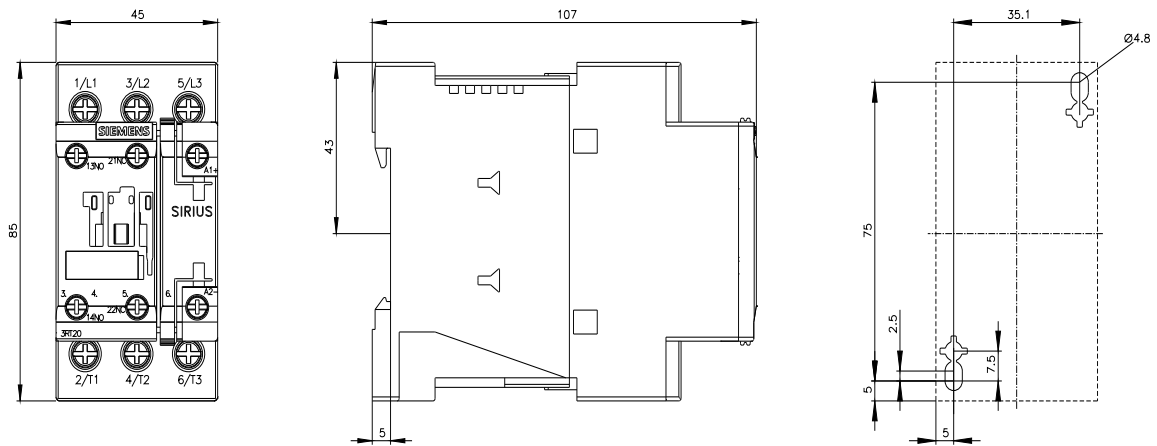



last modified:

10/21/2025