



Withdrawable drive for contactors 3RT105, 3RT145 AC (50...60 Hz) / DC operation, 380 ... 420 V Operating mechanism: Standard,economy circuit Screw terminal

| | |
|--------------------------|--------------------------------|
| product brand name | SIRIUS |
| product category | Solenoid coils |
| product designation | Changeover operating mechanism |
| product type designation | 3RT19 |

| General technical data | |
|---|---------------|
| Substance Prohibitance (Date) | 05/01/2012 |
| Weight | 0.55 kg |
| type of voltage of the control supply voltage | AC/DC |
| control supply voltage 1 at AC | |
| • at 50 Hz | 380 ... 420 V |
| • at 60 Hz | 380 ... 420 V |
| control supply voltage 2 at AC | |
| • at 50 Hz rated value | 420 V |
| • at 60 Hz rated value | 420 V |
| control supply voltage 1 at DC | 380 ... 420 V |
| control supply voltage 2 at DC rated value | 420 V |
| apparent pick-up power of magnet coil at AC | |
| • at 50 Hz | 300 VA |
| • at 60 Hz | 300 VA |
| inductive power factor with closing power of the coil | |
| • at 50 Hz | 0.9 |
| • at 60 Hz | 0.9 |
| apparent holding power of magnet coil at AC | |
| • at 50 Hz | 5.8 VA |
| • at 60 Hz | 5.8 VA |
| inductive power factor with the holding power of the coil | |
| • at 50 Hz | 0.8 |
| • at 60 Hz | 0.8 |

| Approvals Certificates | | |
|--------------------------|-----|-------------------|
| General Product Approval | EMV | Test Certificates |



[Type Test Certificates/Test Report](#)

| | | |
|-------------------|----------------------|-------|
| Test Certificates | Maritime application | other |
|-------------------|----------------------|-------|



| | | |
|-------|---------|-------------|
| other | Railway | Environment |
|-------|---------|-------------|



[Miscellaneous](#)

[Special Test Certificate](#)

[Environmental Confirmations](#)

Further information

Information on the packaging

<https://support.industry.siemens.com/cs/ww/en/view/109813875>

Information for data generation and storage

<https://support.industry.siemens.com/cs/ww/en/view/109995012>

Information- and Downloadcenter (Catalogs, Brochures,...)

<https://www.siemens.com/ic10>

Industry Mall (Online ordering system)

<https://mall.industry.siemens.com/mall/en/en/Catalog/product?mlfb=3RT1955-5AV31>

Cax online generator

<https://support.automation.siemens.com/WW/CAXorder/default.aspx?lang=en&mlfb=3RT1955-5AV31>

Service&Support (Manuals, Certificates, Characteristics, FAQs,...)

<https://support.industry.siemens.com/cs/ww/en/ps/3RT1955-5AV31>

Image database (product images, 2D dimension drawings, 3D models, device circuit diagrams, EPLAN macros, ...)

https://www.automation.siemens.com/bilddb/cax_de.aspx?mlfb=3RT1955-5AV31&lang=en

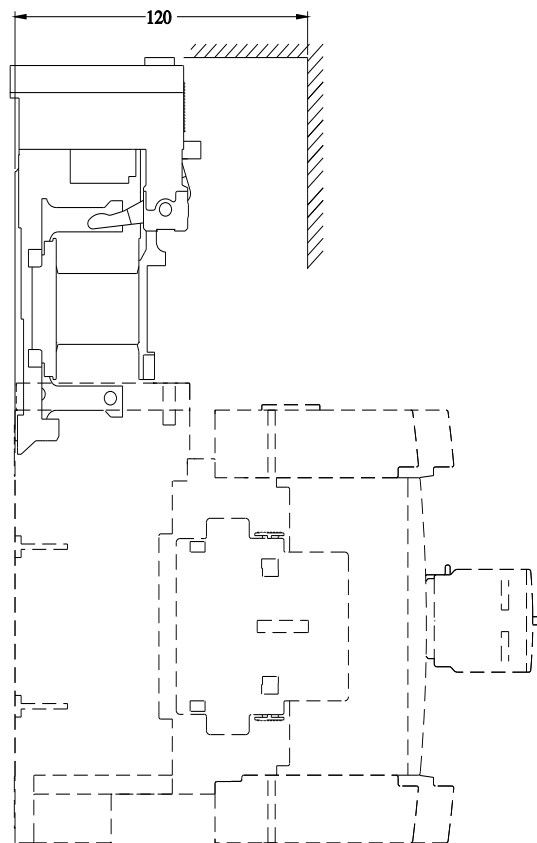
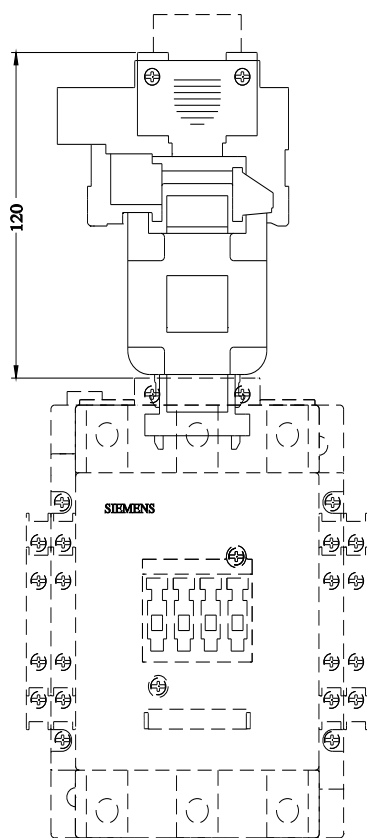



last modified:

4/2/2025 ↻