







Link module for screw terminal Electrical and mechanical complete for load feeders fuseless, Size S0 for standard mounting rail mounting consists of Wiring module busbar adapter and side modules

product brand name	SIRIUS
product category	Wiring modules, connectors and kits
product designation	Link modules
product type designation	3RA29

General technical data	
size of the circuit-breaker	S0
size of contactor	S0
Substance Prohibitance (Date)	10/01/2009
Weight	0.373 kg
number of poles	3

Installation/ mounting/ dimensions	
fastening method	screw fixing

Approvals Certificates

General Product Approval	Test Certificates	Maritime application
 EG-Konf.		 UL
	Type Test Certificates/Test Report	 ABS

Maritime application

		 LRS	 PRS	 RINA	 RMRS
---	---	--	--	---	---

other Environment

[Confirmation](#)



[Environmental Confirmations](#)

Further information

Information on the packaging
<https://support.industry.siemens.com/cs/ww/en/view/109813875>
 Information for data generation and storage
<https://support.industry.siemens.com/cs/ww/en/view/109995012>
 Information- and Downloadcenter (Catalogs, Brochures,...)
<https://www.siemens.com/ic10>

Industry Mall (Online ordering system)

<https://mall.industry.siemens.com/mall/en/en/Catalog/product?mlfb=3RA2923-1BB1>

Cax online generator

<https://support.automation.siemens.com/WW/CAXorder/default.aspx?lang=en&mlfb=3RA2923-1BB1>

Service&Support (Manuals, Certificates, Characteristics, FAQs,...)

<https://support.industry.siemens.com/cs/ww/en/ps/3RA2923-1BB1>

Image database (product images, 2D dimension drawings, 3D models, device circuit diagrams, EPLAN macros, ...)

https://www.automation.siemens.com/bilddb/cax_de.aspx?mlfb=3RA2923-1BB1&lang=en

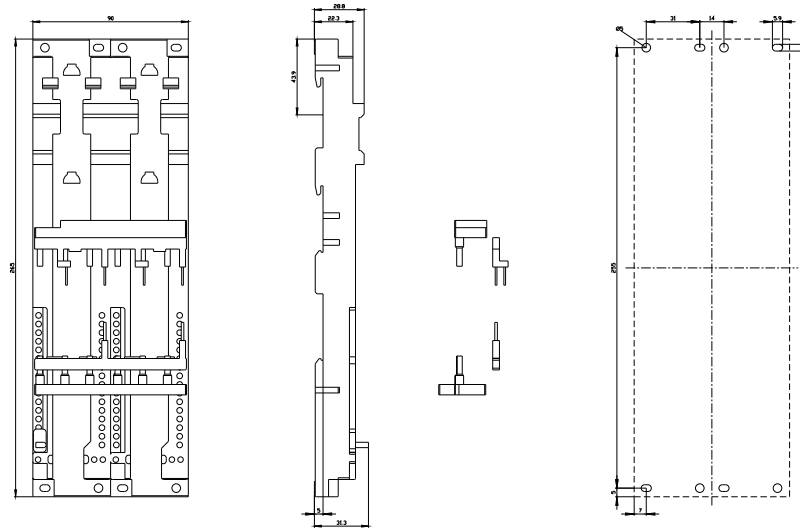

last modified:

4/2/2025 