



Load feeder fuseless, Direct-on-line starting 400 V AC, Size S2 22 ... 32 A 230 V AC, 50 Hz screw terminal for installation on standard mounting rail (also fulfills type of coordination 1) Type of coordination 2, I<sub>q</sub> = 100 kA 1 NO+1 NC (contactor)

|  |                                |
|--|--------------------------------|
| <b>product brand name</b>  | SIRIUS                         |
| <b>product designation</b>   | Direct (on-line) starter       |
| <b>design of the product</b>   | for DIN-rail or screw mounting |
| <b>product type designation</b>  | 3RA21                          |
| <b>manufacturer's article number</b>   |                                |
| • of the supplied contactor  | <a href="#">3RT2035-1AP00</a>  |
| • of the supplied circuit-breakers   | <a href="#">3RV2031-4EA10</a>  |
| • of the supplied link module  | <a href="#">3RA2931-1AA00</a>  |
| <b>General technical data</b>  |                                |
| <b>size of the circuit-breaker</b>   | S2                             |
| <b>size of load feeder</b>   | S2                             |
| <b>power loss [W] for rated value of the current</b>                                       |                                |
| • at AC in hot operating state per pole  | 8.2 W                          |
| • without load current share typical   | 16 W                           |
| insulation voltage with degree of pollution 3 at AC rated value                            | 690 V                          |
| <b>surge voltage resistance rated value</b>  | 6 kV                           |
| <b>degree of protection NEMA rating</b>  | other                          |
| <b>shock resistance according to IEC 60068-2-27</b>  | 6g / 11 ms                     |
| mechanical service life (operating cycles) of contactor typical                            | 10 000 000                     |
| <b>type of coordination</b>  | 2                              |
| <b>reference code according to IEC 81346-2:2019</b>  | Q                              |
| <b>Substance Prohibitance (Date)</b>   | 03/01/2017                     |
| <b>SVHC substance name</b>   | Lead - 7439-92-1               |
| <b>Weight</b>  | 2.152 kg                       |
| <b>Ambient conditions</b>  |                                |
| <b>ambient temperature</b>   |                                |
| • during operation   | -20 ... +60 °C                 |
| • during storage   | -50 ... +80 °C                 |
| • during transport   | -50 ... +80 °C                 |
| <b>temperature compensation</b>  | -20 ... +60 °C                 |
| relative humidity during operation   | 10 ... 95 %                    |
| <b>Main circuit</b>  |                                |
| <b>number of poles for main current circuit</b>  | 3                              |
| <b>design of the switching contact</b>   | electromechanical              |
| <b>adjustable current response value current of the current-dependent overload release</b> | 22 ... 32 A                    |
| <b>operating voltage</b>   |                                |
| • rated value  | 690 V                          |
| • at AC-3 rated value maximum  | 690 V                          |
| • at AC-3e rated value maximum   | 690 V                          |

|  |   |
|--|---|
| <b>operating frequency rated value</b>                                 | 50 ... 60 Hz                                      |
| <b>operational current</b>   |   |
| • at AC-3 at 400 V rated value   | 32 A  |
| • at AC-3e at 400 V rated value  | 32 A  |
| <b>operating power</b>   |   |
| • at AC-3  |   |
| — at 400 V rated value   | 15 000 W  |
| • at AC-3e   |   |
| — at 400 V rated value   | 15 000 W  |
| <b>Control circuit/ Control</b>  |   |
| <b>type of voltage of the control supply voltage</b>                   | AC  |
| <b>control supply voltage at AC</b>                                    |   |
| • at 50 Hz rated value   | 230 V   |
| <b>apparent holding power of magnet coil at AC</b>                     | 16 VA   |
| • at 50 Hz   | 16 VA   |
| <b>inductive power factor with the holding power of the coil</b>       | 0.37  |
| • at 50 Hz   | 0.37  |
| <b>Auxiliary circuit</b>   |   |
| <b>product extension auxiliary switch</b>                              | Yes   |
| <b>Protective and monitoring functions</b>                             |   |
| <b>trip class</b>  | CLASS 10  |
| <b>design of the overload release</b>                                  | thermal (bimetallic)                              |
| <b>response value current of instantaneous short-circuit trip unit</b> | 416 A   |
| <b>UL/CSA ratings</b>  |   |
| <b>full-load current (FLA) for 3-phase AC motor</b>                    |   |
| • at 480 V rated value   | 32 A  |
| • at 600 V rated value   | 32 A  |
| <b>yielded mechanical performance [hp]</b>                             |   |
| • for single-phase AC motor  |   |
| — at 110/120 V rated value   | 2 hp  |
| — at 230 V rated value   | 5 hp  |
| • for 3-phase AC motor   |   |
| — at 200/208 V rated value   | 10 hp   |
| — at 220/230 V rated value   | 10 hp   |
| — at 460/480 V rated value   | 20 hp   |
| <b>Short-circuit protection</b>  |   |
| <b>product function short circuit protection</b>                       | Yes   |
| <b>design of the short-circuit trip</b>                                | magnetic  |
| <b>conditional short-circuit current (I<sub>q</sub>)</b>               |   |
| • at 400 V according to IEC 60947-4-1 rated value                      | 100 000 A   |
| <b>Installation/ mounting/ dimensions</b>                              |   |
| <b>mounting position</b>   | vertical, horizontal                              |
| <b>fastening method</b>  | screw and snap-on mounting to two 35 mm DIN rails |
| <b>height</b>  | 274 mm  |
| <b>width</b>   | 55 mm   |
| <b>depth</b>   | 150 mm  |
| <b>required spacing</b>  |   |
| • for grounded parts   |   |
| — forwards   | 32 mm   |
| — backwards  | 0 mm  |
| — upwards  | 50 mm   |
| — at the side  | 10 mm   |
| — downwards  | 10 mm   |
| • for live parts   |   |
| — forwards   | 32 mm   |
| — backwards  | 0 mm  |
| — upwards  | 50 mm   |
| — downwards  | 10 mm   |
| — at the side  | 10 mm   |
| <b>Connections/ Terminals</b>  |   |

|   |   |
|---|---|
| <b>type of electrical connection</b>  |   |
| <ul style="list-style-type: none"> <li>• for main current circuit</li> <li>• for auxiliary and control circuit</li> </ul> | <p>screw-type terminals</p> <p>screw-type terminals</p> |
| <b>Safety related data</b>  |   |
| product function suitable for safety function   | Yes   |
| <b>Electrical Safety</b>  |   |
| <b>touch protection on the front according to IEC 60529</b>   | finger-safe, for vertical contact from the front        |
| <b>Communication/ Protocol</b>  |   |
| <b>protocol is supported</b>  |   |
| <ul style="list-style-type: none"> <li>• PROFINET IO protocol</li> <li>• PROFIsafe protocol</li> </ul>                    | <p>No</p> <p>No</p>                                     |
| protocol is supported AS-Interface protocol   | No  |

**Approvals Certificates**

|                                 |                                       |                          |
|---------------------------------|---------------------------------------|--------------------------|
| <b>General Product Approval</b> | <b>For use in hazardous locations</b> | <b>Test Certificates</b> |
|---------------------------------|---------------------------------------|--------------------------|



[Special Test Certificate](#)

**Test Certificates**      **Maritime application**

[Type Test Certificates/Test Report](#)



**Maritime application**      **other**      **Railway**      **Dangerous goods**



[Confirmation](#)

[Special Test Certificate](#)

[Transport Information](#)

**Environment**

[Environmental Conformations](#)

**Further information**

**Information on the packaging**

<https://support.industry.siemens.com/cs/ww/en/view/109813875>

**Information for data generation and storage**

<https://support.industry.siemens.com/cs/ww/en/view/109995012>

**Information- and Downloadcenter (Catalogs, Brochures,...)**

<https://www.siemens.com/ic10>

**Industry Mall (Online ordering system)**

<https://mall.industry.siemens.com/mall/en/en/Catalog/product?mlfb=3RA2130-4EA35-0AP0>

**Cax online generator**

<https://support.automation.siemens.com/WW/CAXorder/default.aspx?lang=en&mlfb=3RA2130-4EA35-0AP0>

**Service&Support (Manuals, Certificates, Characteristics, FAQs,...)**

<https://support.industry.siemens.com/cs/ww/en/ps/3RA2130-4EA35-0AP0>

**Image database (product images, 2D dimension drawings, 3D models, device circuit diagrams, EPLAN macros, ...)**

[https://www.automation.siemens.com/bilddb/cax\\_de.aspx?mlfb=3RA2130-4EA35-0AP0&lang=en](https://www.automation.siemens.com/bilddb/cax_de.aspx?mlfb=3RA2130-4EA35-0AP0&lang=en)

**Characteristic: Tripping characteristics, I<sup>t</sup>, Let-through current**

<https://support.industry.siemens.com/cs/ww/en/ps/3RA2130-4EA35-0AP0/char>

**Further characteristics (e.g. electrical endurance, switching frequency)**

<https://www.automation.siemens.com/bilddb/index.aspx?view=Search&mlfb=3RA2130-4EA35-0AP0&objecttype=14&gridview=view1>

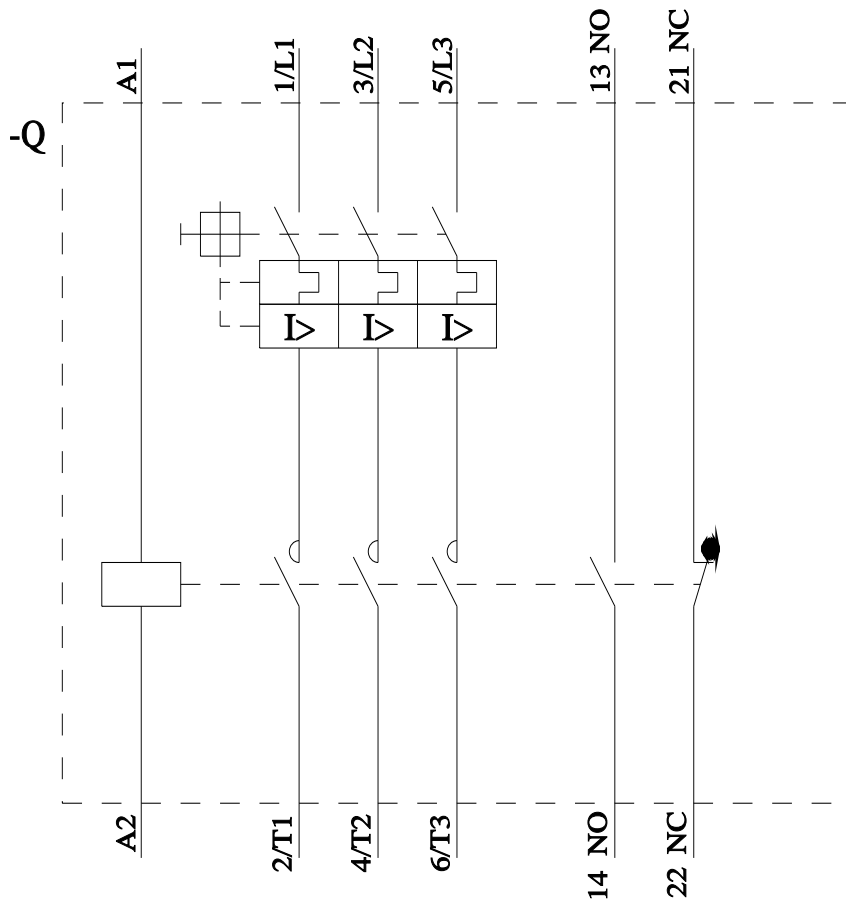
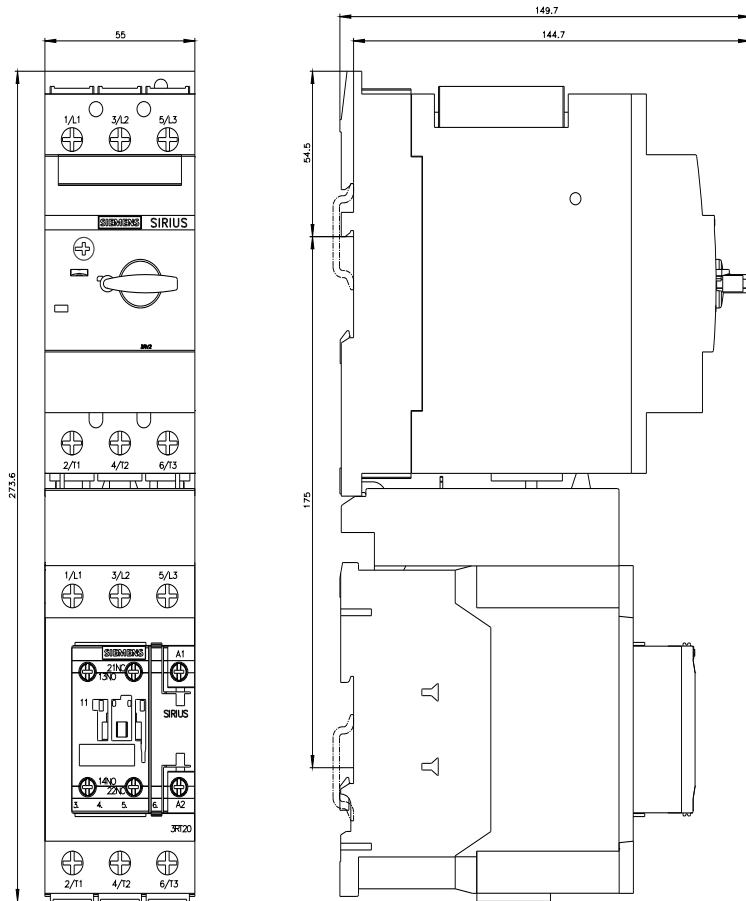

last modified:

4/1/2025

