



PE-through terminal, Floor installation, accessory for Load disconnecter 3LD3

| Model | | |
|---|---|-------------|
| product brand name | SETRON | |
| product designation | PE through-type terminal | |
| design of the product | accessories for 3LD3 switch disconnectors | |
| Accessories | | |
| accessories | floor mounting | |
| AWG number as coded connectable conductor cross section | | |
| <ul style="list-style-type: none"> • minimum • maximum | 14 6 | |
| tightening torque with screw-type terminals | | |
| <ul style="list-style-type: none"> • minimum • maximum | 3 N·m 3 N·m | |
| type of connectable conductor cross-sections for main contacts | | |
| <ul style="list-style-type: none"> • finely stranded with core end processing • solid or stranded | 1x (2.515 mm ²) 1x (2.5 ... 16 mm ²) | |
| Mechanical Design | | |
| Net Weight | 40 g | |
| Approvals Certificates | | |
| General Product Approval | other | Environment |



[Confirmation](#)

[Environmental Confirmations](#)

Environment

[Environmental Confirmations](#)

Further information

Information on the packaging
<https://support.industry.siemens.com/cs/ww/en/view/109813875>
 Information for data generation and storage
<https://support.industry.siemens.com/cs/ww/en/view/109995012>
 Information- and Downloadcenter (Catalogs, Brochures,...)
<http://www.siemens.com/lowvoltage/catalogs>
 Industry Mall (Online ordering system)

<https://mall.industry.siemens.com/mall/en/en/Catalog/product?mlfb=3LD9340-3C>

Service&Support (Manuals, Certificates, Characteristics, FAQs,...)

<https://support.industry.siemens.com/cs/ww/en/ps/3LD9340-3C>

Image database (product images, 2D dimension drawings, 3D models, device circuit diagrams, ...)

http://www.automation.siemens.com/bilddb/cax_en.aspx?mlfb=3LD9340-3C

CAX-Online-Generator

<http://www.siemens.com/cax>

Tender specifications

<https://www.siemens.com/specifications>

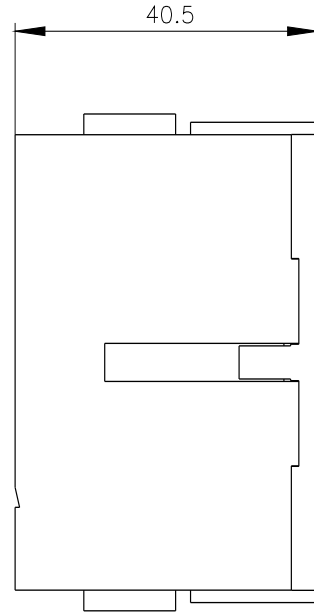
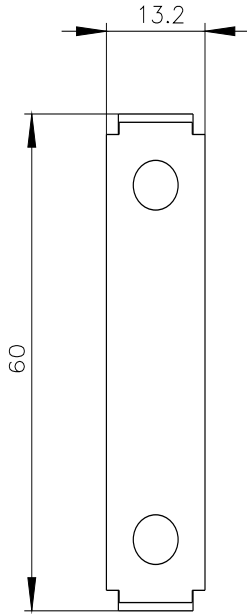

last modified:

4/12/2025 

