



Neutral conductor/PE terminal, continuous, for front mounting, accessory for main and emergency switching-off switch 3LD25 for 63A and for molded case switch 3LD5 UL for 30A

Model	
product brand name	SETRON
product designation	Neutral conductor/PE terminal
design of the product	accessories for 3LD25 main and EMERGENCY-STOP switches
Accessories	
accessories	through-type, for front mounting, up to 63 A
AWG number as coded connectable conductor cross section	
• minimum	14
• maximum	6
type of connectable conductor cross-sections for main contacts	
• finely stranded with core end processing	1x (2.5...35 mm ²)
• solid or stranded	1x (2.5 ... 16 mm ²)
Mechanical Design	
Net Weight	69 g
Approvals Certificates	
General Product Approval	other



other	Environment
Confirmation	Environmental Confirmations Environmental Confirmations

Further information

- Information on the packaging <https://support.industry.siemens.com/cs/ww/en/view/109813875>
- Information for data generation and storage <https://support.industry.siemens.com/cs/ww/en/view/109995012>
- Information- and Downloadcenter (Catalogs, Brochures,...) <http://www.siemens.com/lowvoltage/catalogs>
- Industry Mall (Online ordering system) <https://mall.industry.siemens.com/mall/en/en/Catalog/product?mlfb=3LD9250-2BA>
- Service&Support (Manuals, Certificates, Characteristics, FAQs,...) <https://support.industry.siemens.com/cs/ww/en/ps/3LD9250-2BA>
- Image database (product images, 2D dimension drawings, 3D models, device circuit diagrams, ...)

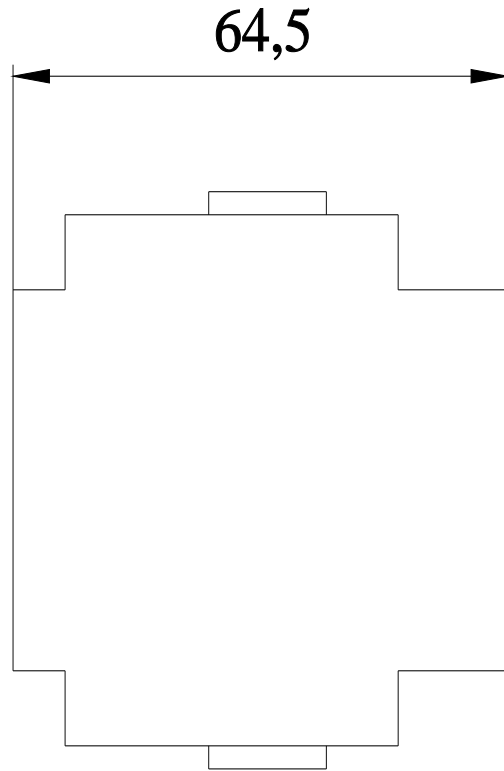
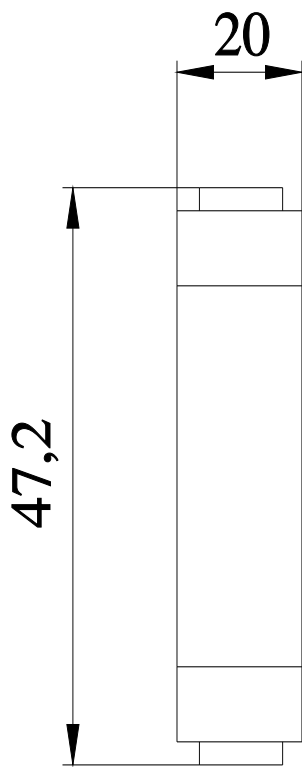

last modified:

4/12/2025 

